

## Typical specifications

# ROOFING

### 1 Timber roof deck with free standing kerb (cold roof)

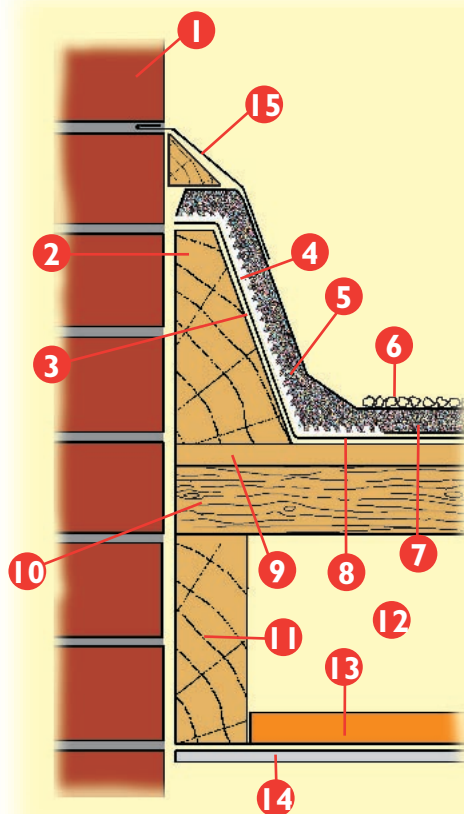

- |   |   |
|---|---|
| 1) BRICKWORK  | 13) THERMAL INSULANT  |
| 2) FREE STANDING TIMBER KERB  | 14) FOIL PACKED PLASTER BOARD   |
| 3) SEPARATING MEMBRANE  | 15) FLASHING FIXED WITH TRADITIONAL PLUMBERS DETAIL INCLUDING TIMBER FILLET |
| 4) EXPANDED METAL LATHING   |   |
| 5) MIN. 150MM HIGH 20MM THREE COAT MASTIC ASPHALT SKIRTING WITH ANGLE FILLET AND SOLAR REFLECTIVE PAINT |   |
| 6) SOLAR REFLECTIVE TREATMENT   | 1) 20MM THREE COAT MASTIC ASPHALT   |
| 7) 20MM TWO COAT MASTIC ASPHALT   | 2) 20MM THREE COAT MASTIC ASPHALT   |
| 8) SEPARATING MEMBRANE  | 3) EXPANDED METAL LATHING NAILED AT 150MM CENTRES                           |
| 9) PLYWOOD BOARDING OR SIMILAR  | 4) SEPARATING MEMBRANE  |
| 10) CROSS FIRRING   | 5) FREE STANDING KERB   |
| 11) TIMBER JOIST  | 6) PLYWOOD BOARDING   |
| 12) VENTILATED SPACE  | 7) TIMBER JOIST   |

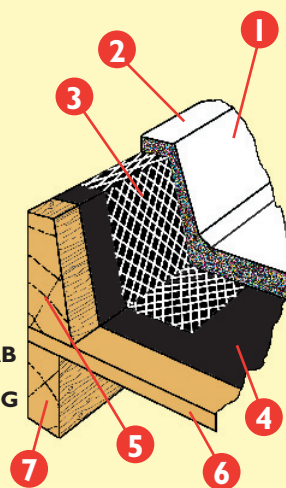

### 2 Timber roof deck with free standing kerb (warm roof)

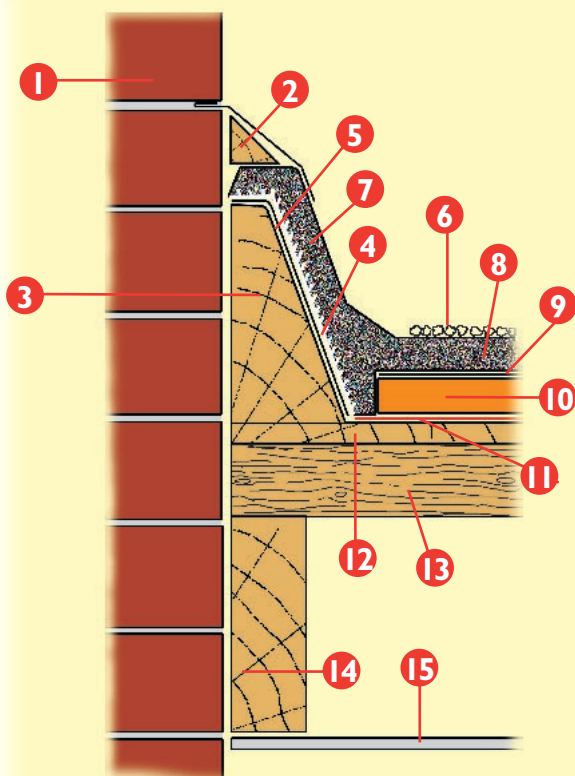

- |   |
|---|
| 1) BRICKWORK  |
| 2) FLASHING FIXED WITH TRADITIONAL PLUMBERS DETAIL INCLUDING TIMBER FILLET                              |
| 3) FREE STANDING TIMBER KERB  |
| 4) EXPANDED METAL LATHING   |
| 5) SEPARATING MEMBRANE  |
| 6) SOLAR REFLECTIVE TREATMENT   |
| 7) MIN. 150MM HIGH 20MM THREE COAT MASTIC ASPHALT SKIRTING WITH ANGLE FILLET AND SOLAR REFLECTIVE PAINT |
| 8) 20MM TWO COAT MASTIC ASPHALT   |
| 9) SEPARATING MEMBRANE  |
| 10) BOARD TYPE THERMAL INSULANT   |
| 11) VAPOUR CONTROL LAYER  |
| 12) PLYWOOD BOARDING OR SIMILAR   |
| 13) CROSS FIRRING   |
| 14) TIMBER JOIST  |
| 15) FOIL PACKED PLASTER BOARD   |