

3 Externally applied mastic asphalt tanking under foundations

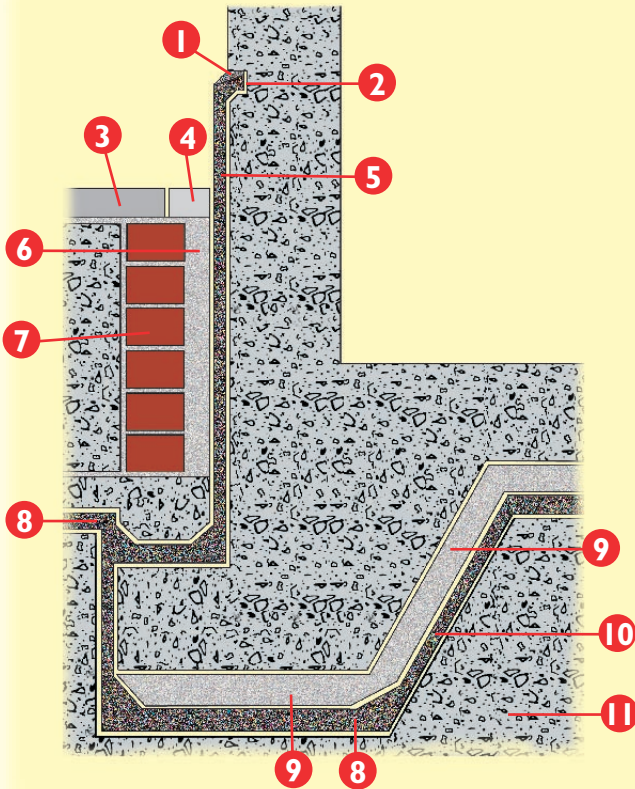

- 1) CEMENT MORTAR POINTING
- 2) 25MM X 25MM CHASE CAST IN CONCRETE
- 3) GROUND LEVEL
- 4) PAVING SLABS KEPT BACK 75MM AND GAP FILLED WITH GRAVEL OR SUITABLE SOFT FILLER
- 5) 20MM THREE COAT MASTIC ASPHALT WITH FILLET TO HORIZONTAL
- 6) 40MM SPACE FLUSHED UP WITH MORTAR (COURSE BY COURSE)
- 7) PROTECTING BRICKWORK
- 8) 30MM THREE COAT MASTIC ASPHALT
- 9) 50MM PROTECTIVE SAND AND CEMENT SCREED
- 10) 20MM THREE COAT MASTIC ASPHALT WITH FILLET TO HORIZONTAL
- 11) CONCRETE BASE

TANKING

4 Externally applied mastic asphalt tanking over pile caps or under column bases

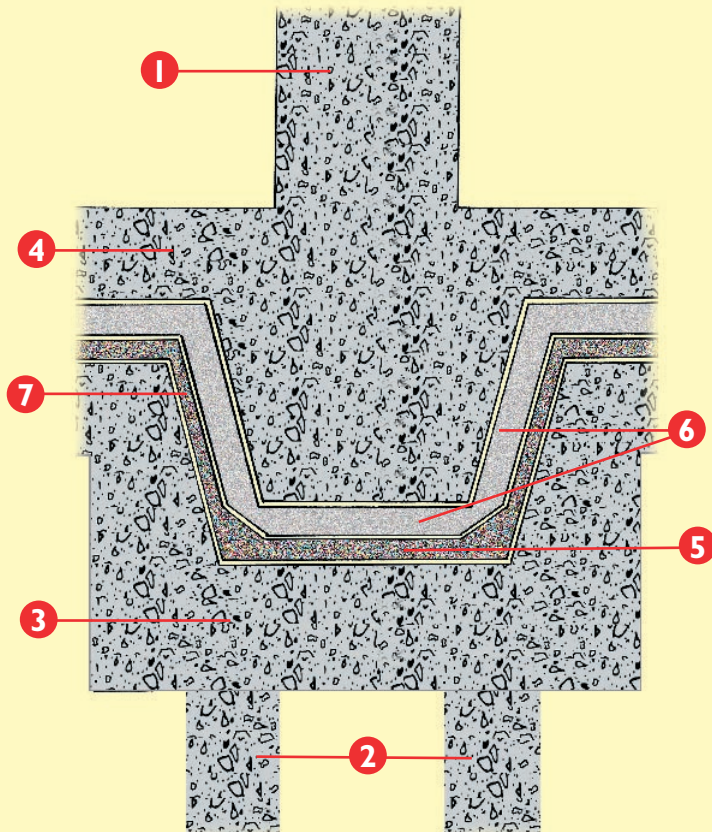

- 1) REINFORCED CONCRETE COLUMN
- 2) PILES
- 3) CONCRETE PILE CAP
- 4) REINFORCED CONCRETE STRUCTURAL WALL AND FLOOR
- 5) 30MM THREE COAT MASTIC ASPHALT
- 6) 50MM PROTECTIVE SAND AND CEMENT SCREED
- 7) 20MM THREE COAT MASTIC ASPHALT WITH FILLET TO HORIZONTAL