

- 1) CEMENT MORTAR POINTING
- 2) 20MM THREE COAT SKIRTING WITH ANGLE FILLET AND SOLAR REFLECTIVE PAINT (TO BE MIN. 150MM ABOVE PAVED LEVEL)
- 3) FLEXIBLE NON BIODEGRADABLE BOARD
- 4) CONCRETE PAVING SLABS
- 5) MORTAR BEDDING
- 6) WATERPROOF BUILDING PAPER OR SINGLE LAYER ROOFING FELT
- 7) 30MM THREE COAT MASTIC ASPHALT
- 8) GLASS FIBRE TISSUE SEPARATING MEMBRANE
- 9) CEMENTITIOUS SCREED LAID TO FALLS
- 10) CONCRETE DECK

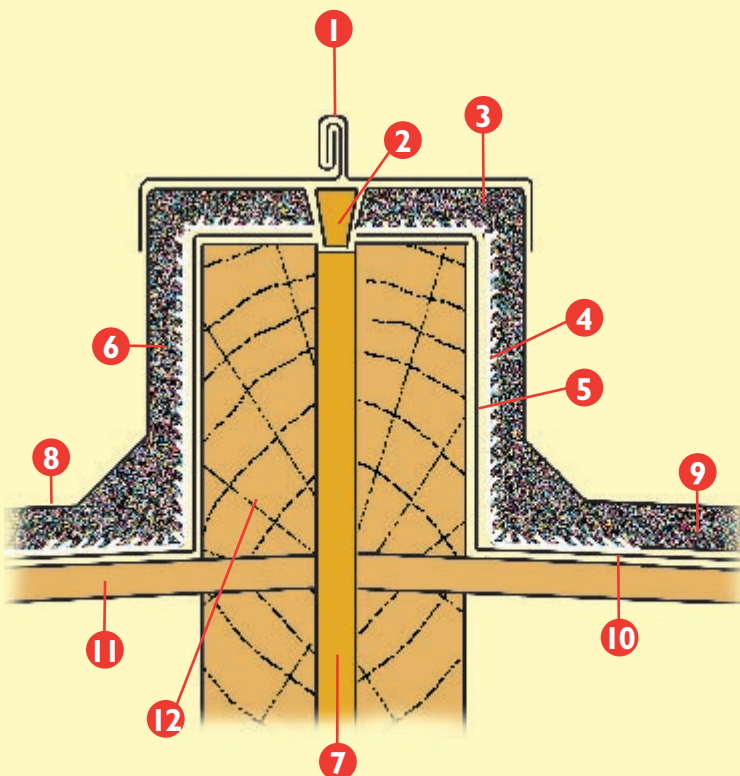

- 1) FLASHING FIXED WITH TRADITIONAL PLUMBERS' DETAIL
- 2) WATERPROOF JOINT FILLER
- 3) 20MM TWO COAT MASTIC ASPHALT
- 4) EXPANDED METAL LATHING
- 5) SEPARATING MEMBRANE
- 6) MIN. 150MM HIGH 20MM THREE COAT MASTIC ASPHALT SKIRTING WITH ANGLE FILLET AND SOLAR REFLECTIVE PAINT
- 7) COMPRESSIBLE INFILL
- 8) SOLAR REFLECTIVE TREATMENT
- 9) 20MM TWO COAT MASTIC ASPHALT
- 10) SEPARATING MEMBRANE
- 11) PLYWOOD BOARDING OR SIMILAR
- 12) TIMBER UPSTAND